

CLEANMAX[®]

ZOOM



Operation and Maintenance Manual

ZM-200

CONTENTS

Getting Started

- Introduction..... 3
- Warranty..... 3
- Grounding Instructions..... 4
- Important Safety Instructions..... 5
- Technical Specifications..... 7
- Assembling the Vacuum 8

Vacuum Features

- On/Off Switch..... 10
- Edge Cleaning..... 10
- Automatic Carpet Height Adjustment..... 10

How To

- Change the Vacuum Bag 11
- Remove/Install the Bottom Plate 12
- Change the Belt 13
- Reset the Circuit Breaker..... 14

For Best Performance 15

Replacement Parts 15



Warranty

Please visit <https://www.cleanmaxvacuums.com/register-warranty.html> to learn more about your warranty and confirm your information.



Warning Labels

Prior to operating the unit, read and understand completely this owner's manual paying special attention to warning labels. These labels indicate a potentially hazardous situation that could result in death or serious injury if not avoided. Use only as described in this manual.



Important

There are no owner serviceable parts inside this machine. Removal of screws and accessing internal components will void all warranty claims.

Your new CleanMax unit is a high quality, precision-made product. All parts used in the manufacturing of this unit have passed rigid quality control standards prior to assembly. Please safeguard the original receipt/invoice given at the time of purchase. If you experience any problems with your unit during the warranty period, the original receipt/invoice will act as proof of purchase.

Upon receipt, inspect outer box for exterior damage. Unpack all internal parts, ensure all items are present according to the owner's manual, and review components for damage.

Each unit is tested and thoroughly inspected prior to shipping. If damage is discovered, immediately notify the transportation company that delivered your machine and request an inspection. As a manufacturer, we are unable to act upon any claim for concealed damage and you must originate the claim. Be sure to keep the carton, packing inserts, and carrier's receipt until the inspector has verified your claim.

GROUNDING INSTRUCTIONS

WARNING!

Improper connection of the equipment-grounding conductor can result in a risk of electric shock. Check with a qualified electrician or service person if you are in doubt as to whether the outlet is properly grounded. DO NOT modify the plug provided with the vacuum. If it will not fit the outlet, have a proper outlet installed by a qualified electrician.

This vacuum cleaner must be grounded. If it should malfunction or break down, grounding provides a path of least resistance for electric current to reduce the risk electric shock. This vacuum cleaner is equipped with a cord having an equipment-grounding conductor and grounding plug. The plug must be plugged into an appropriate outlet that is properly installed and grounded in accordance with all local codes and ordinances.

This vacuum cleaner is for use on a nominal 115-volt circuit and has a ground plug (see illustration). Make sure that the vacuum is connected to an outlet having the same configuration as the plug. No adapter should be used with this vacuum.

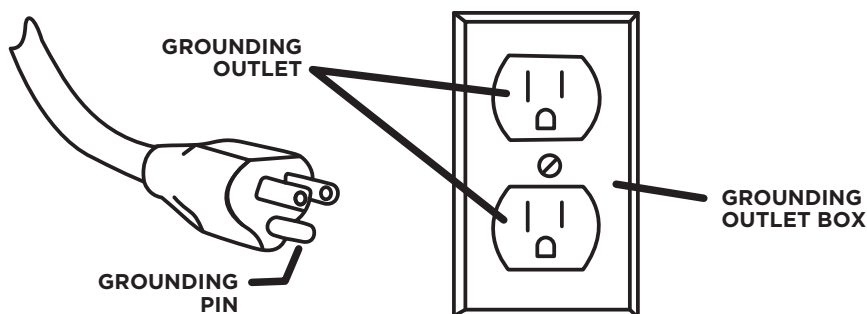

IMPORTANT SAFETY INSTRUCTIONS

READ AND UNDERSTAND ALL INSTRUCTIONS BEFORE USING THIS UNIT

Read and understand this owner's manual and all labels on the unit before operating. Safety is a combination of common sense, staying alert, and knowing how your unit works. Use this unit only as described in this manual. Use only manufacturer's recommended attachments. To reduce the risk of personal injury or damage to your unit use only recommended accessories.

WARNING To avoid fire, DO NOT use with a flammable or combustible liquid or floor cleaner.

WARNING To avoid electric shock, DO NOT expose to rain. Store Indoors.

When using this unit, basic precautions should always be followed, including the following:

- DO NOT leave unit when plugged in. Unplug from outlet when not in use and before servicing.
- DO NOT allow unit to be used as a toy. Close attention is necessary when used around or near children.
- Use only as described in this manual. Use only manufacturer's recommended attachments.
- DO NOT use with damaged cord or plug. If unit is not working properly because it has been dropped, dropped into water, left outdoors, or damaged in any way, contact a service center
- DO NOT handle plug or appliance with wet hands.
- DO NOT put any objects into openings.
- DO NOT use with any opening blocked: keep free of dust, lint, hair, or anything that may reduce air flow.
- Keep hair, loose clothing, fingers, and all parts of body away from openings and moving parts.
- DO NOT pick up anything that is smoking or burning such as cigarettes, matches, or hot ashes.
- DO NOT use to pick up hazardous chemicals.
- Turn off all controls before unplugging.
- Turn unit off immediately if foam or liquid comes from machine exhaust. .
- DO NOT use to pick up flammable or combustible liquids such as gasoline or use in areas where they may be present.
- DO NOT use where oxygen or anesthetics are used.
- Replace damaged or worn parts immediately with genuine original equipment parts to maintain safety.
- This unit must be connected to a properly grounded outlet only. See grounding instructions.
- DO NOT use equipment out of doors or in the rain.
- DO NOT use equipment near or around flammable or explosive materials, fuels, or solvents.
- DO NOT allow the unit to freeze.
- Anyone designated to operate this equipment must, without fail, read and thoroughly understand all instructions and precautions prior to use.
- Do not operate in standing water.
- Do not operate equipment under any unsafe condition.

SAVE THESE INSTRUCTIONS

IMPORTANT SAFETY INSTRUCTIONS



Flammability Warning

NEVER fill unit with flammable chemicals. Do NOT use in an area where flammable fumes are present.



State of California Proposition 65 Warnings

WARNING: This product contains one or more chemicals known to the state of California to cause cancer.

WARNING: This product contains one or more chemicals known to the state of California to cause birth defects or other reproductive harm.



Intended Use

Do NOT modify this unit in any way or adapt it for any use. Modification of this unit in any way will void all warranties and could create safety hazards.

TECHNICAL SPECIFICATIONS

Model	ZOOM 200	
Product Code	ZM-200	
Voltage AC (-)/ Frequency	V/Hz	115/60
Construction Class		II
Nozzle Width	Inches	12
Drive Belt		Flat Stretch
Vacuum Motor Power	A/W	5.5/660
Filtration		HEPA Bag
Airflow Rate	l/s/cfm	1470/115
Capacity	litres/quarts	7/7.4
Productivity Rate	m ² /h/sq.ft./hr	209/2250
Sound pressure level	dB(A)	79
Dimensions (L x W x H)	mm/inches	254 x 330 x 1156/10 x 13 x 45.5
Weight w/o Cord	kg/lbs.	3.6/8
Cable length	m/ft	10.6/35 18/3 SJT
Ingress Protection Rating		IP20
Certification		cULus

ASSEMBLING THE VACUUM

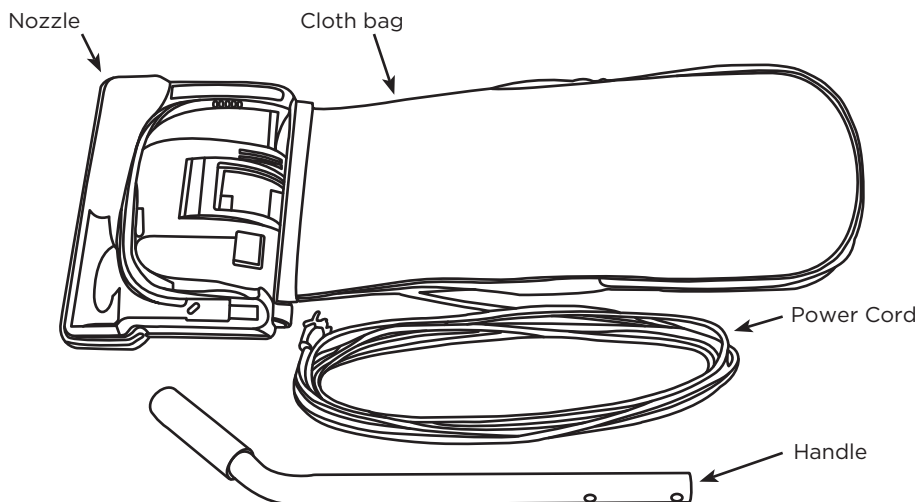

Important Note

Under no circumstances should you plug in the vacuum cleaner prior to complete assembly.

The vacuum cleaner handle is packed as a separate component that requires assembly.

Installing the Handle

1. Release the handle bracket from the handle tube by removing the two screws (Fig. 1).
2. Place handle onto the handle tube, aligning holes with pegs (Fig. 2).
3. Place the handle bracket back into position (Fig. 3).
4. Secure with two screws removed in step 1.

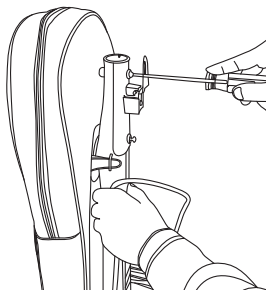

Fig. 1

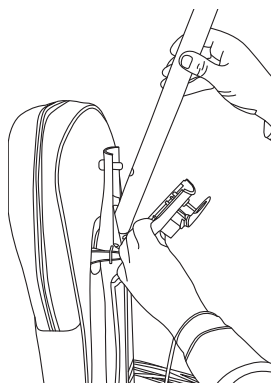

Fig. 2

Positioning the Power Cord

1. Loosen, but do not remove, the screw holding the upper cord hook (Fig. 4).
2. Position the cord between the cord hook and the vacuum tube (Fig. 5).
Re-tighten the screw.
3. Once the cord is secured by the cord hook, proceed with wrapping the cord.
4. Wrap the cord clockwise around the top and bottom cord hooks (Fig. 6). Fasten the plug to the wrapped cord using the channel on the plug. When not in use store the appliance indoors in a clean dry area where it can't be damaged or cause injury.

Note: Before wrapping the cord onto the unit, make sure it is unplugged from the wall outlet.

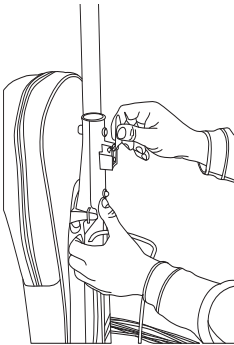

Fig. 3

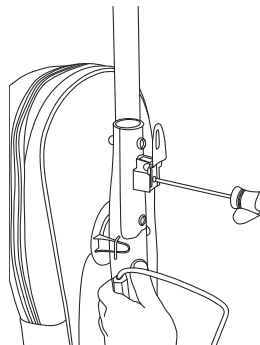

Fig. 4

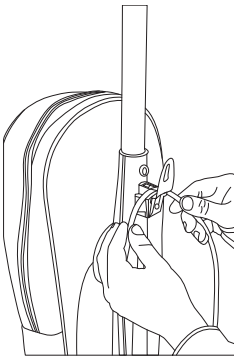

Fig. 5

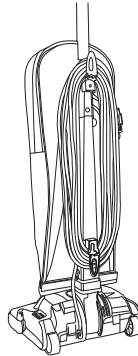

Fig. 6

VACUUM FEATURES

On/Off Switch

Locate the switch on the back side of the nozzle to the left of the handle tube (see Fig. 7). Simply press the switch with your foot to turn the vacuum on or off.

Do not run the vacuum over the power cord.

Always turn the vacuum cleaner off before unplugging it from the electrical outlet.

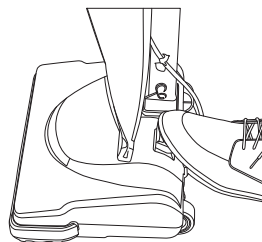

Fig. 7

Edge Cleaning

The edge cleaning feature provides improved cleaning near walls and stationary furniture. For maximum edge cleaning, place the left side of the nozzle against the wall or stationary furniture.

Automatic Carpet Height Adjustment

Your vacuum is designed with an automatic, self-adjusting nozzle. No manual adjustments are required. The height of the nozzle is instantly and automatically adjusted to the flooring surface. This self-adjusting feature allows the nozzle to float evenly over all flooring surfaces.

Change the Vacuum Bag

CAUTION: First, unplug the vacuum cleaner from the electrical outlet.

1. Unzip outer cloth bag (Fig. 8).
2. Remove used bag by pressing the bag holder tab and pulling bag off vacuum (Fig. 9). Discard used bag.
3. To install new bag, position the bottom of the bag collar into the bag collar holder (Fig. 10).
4. Push the top of the bag collar inward until the collar “snaps” into place under the bag holder tab.
5. Zip the outer cloth bag closed.

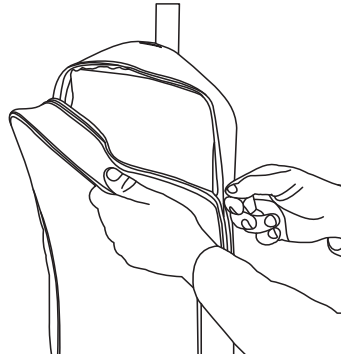

Fig. 8

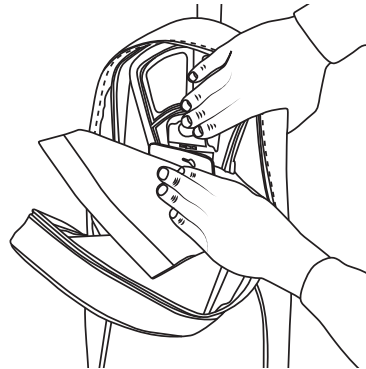

Fig. 9

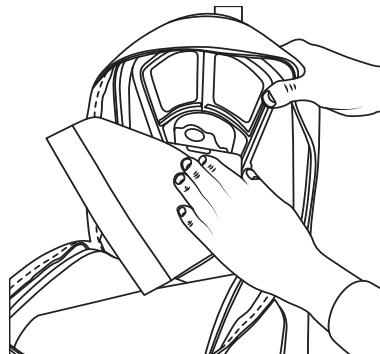

Fig. 10

HOW TO

Remove/Install the Bottom Plate

CAUTION: First, unplug the vacuum cleaner from the electrical outlet.

To Remove the Bottom Plate

1. After unplugging the power cord, turn the vacuum cleaner over, exposing the underside.
2. Press the two holding tabs inward (Fig. 11) releasing the bottom plate. Remove the bottom plate.

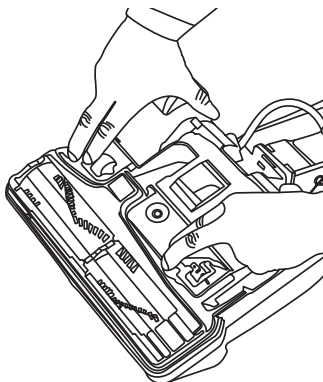

Fig. 11

To Install the Bottom Plate

1. Install bottom plate, making sure bottom plate hinges are in place before setting the plate (Fig. 12).
2. Press plate into position until the plate “clicks” on both sides.

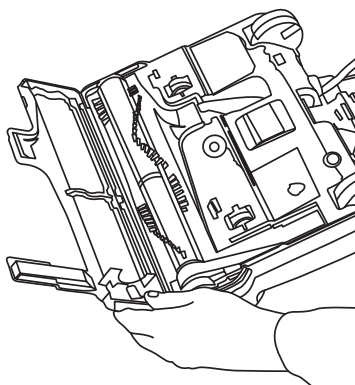

Fig. 12

Change the Belt

CAUTION: First, unplug the vacuum cleaner from the electrical outlet.

1. Turn the unit over and remove the bottom plate (see “How to Remove Bottom Plate”).
2. Remove the brushroll and the worn or broken belt from the brushroll pulley and the motor drive shaft (Fig. 13).
3. Loop the new belt around the motor drive shaft and the brushroll (Fig. 14).
4. Reinstall the brushroll back into the housing. Turn the brushroll by hand, making sure the belt is not twisted and all rotating parts move smoothly (Fig. 15).
5. Reinstall the bottom plate (see “How to Install Bottom Plate”).

NOTE: To ensure maximum cleaning efficiency, the belt should be checked regularly to be sure it is in good condition. Replace the belt if it is stretched, cracked, or if excessive slipping is occurring.

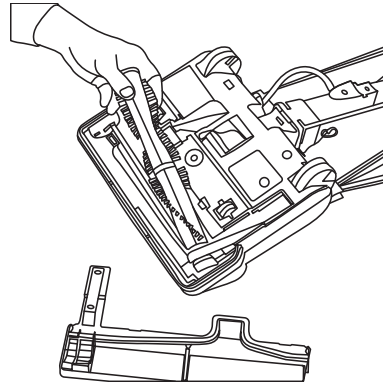

Fig. 13

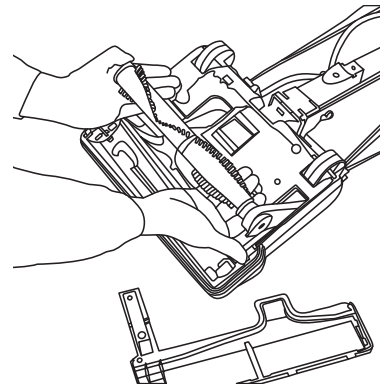

Fig. 14

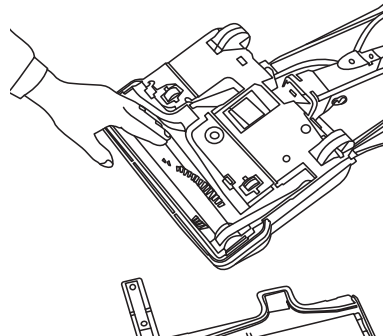

Fig. 15

HOW TO

Reset the Circuit Breaker

Your vacuum features a circuit breaker to protect the machine against damage due to a surge in the electrical current. Electrical surging can be a result of, though not limited to, a jammed brushroll (i.e. vacuuming up a throw rug) or a jammed motor fan.

Should your vacuum cleaner experience a jammed brushroll with the circuit breaker tripping, first press the on/off button to the off position and unplug the unit. Inspect the brushroll by removing the bottom plate (see “How to Remove Bottom Plate”) and remove any debris which may be causing the jam. Reinstall the bottom plate (see “How to Install Bottom Plate”), reset the circuit breaker by pressing the Circuit Breaker Reset Button (Fig. 16), plug in power cord, and turn unit on. If the unit fails to turn on, return to the place where you purchased your unit for assistance.

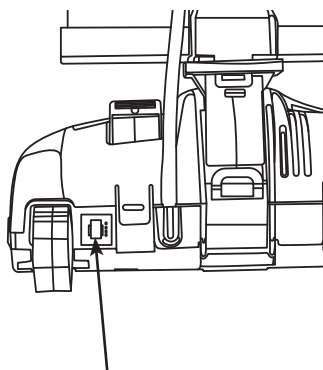

Circuit Breaker Reset button

Fig. 16

FOR BEST PERFORMANCE

For Best Performance

- Keep your vacuum clean and in good operating condition.
- Change vacuum bags when the bags are 2/3 full to maximize cleaning performance.
- Always use genuine vacuum bags and replacement parts. Use of other products may result in poor cleaning performance, potential vacuum cleaner damage and may void vacuum warranty. Genuine products are designed for maximum cleaning performance.
- Have your machine checked periodically by the retailer where you purchased your vacuum.
- Store your machine carefully in a dry area.
- For optimum cleaning performance and safety, follow your owner's manual instructions.

REPLACEMENT PARTS

- Genuine Zoom HEPA Media Vacuum Bags - Part # CMZM-H6
- Genuine Zoom Paper Vacuum Bags - Part #CMZM-P6
- Genuine Zoom Vacuum Belts - Part # CMZM-B2



CleanMax Vacuums
P.O. Box 730
Fenton, MO 63026



Record of Purchase

Serial Number: _____

Purchase Date: _____

Dealer: _____

Phone Number: _____